

KE-27

Stainless Steel Cleaner & Polish

CLEANS, POLISHES, BRIGHTENS

Quickly cleans all types of stainless steel and polished metal surfaces leaving a sparkling finish

SUPERB CLEANSING

Ideally suited wherever there are stainless steel surfaces to be cleaned -- kitchens, elevators, tank systems

NO HARMFUL ABRASIVES

Non-abrasive cleaning action removes dirt, grease, and smudges. Products a durable satin or mirror gloss.

PROTECTS AGAINST OXIDATION

Quickly and effectively removes oil and resists fingerprints, water stains, and oxidation. Leaves an invisible film that protects surfaces.

FRESHENS AIR

Pleasant **LEMON FRAGRANCE** leaves areas smelling as good as it looks.

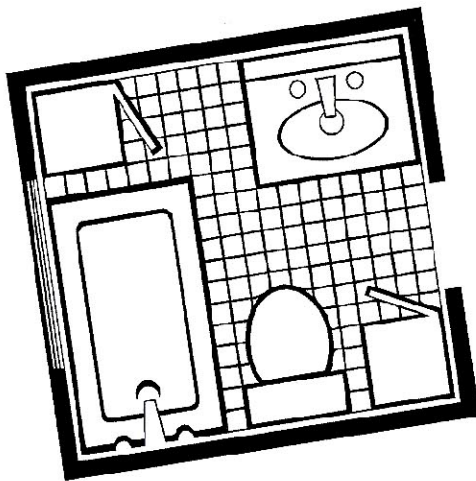

Kinzu Environmental, Inc.
Cleveland, Oh. 44114
800-233-5079
www.kinzuachem.com

DESCRIPTION

KE-27

This stainless steel cleaner/protector represents the best combination of ingredients to remove both water and oil-base soils, stains and spills. Ideal for all brushed and high gloss metal surfaces. Quickly eliminates all dirt, grease, fingerprints and oxidation leaving the surface sparkling clean, spot free and shining with no greasy film. Can also be used to clean, protect and restore the finish on painted steel and wood panel.

APPLICATIONS

Cleans, polishes, brightens, protects all stainless steel surfaces including: Restaurant and food processing equipment, Refrigerator doors, Food-serving areas, Counter tops, Hospital and medical equipment, Elevator doors, Chrome, Aluminum, Copper, Brass, Formica, Porcelain, Painted metal



PRECAUTIONS

Keep out of the reach of children. Possible eye irritant. Do not take internally. Do not inhale spray or vapors. Avoid contact with skin, eyes, and clothing. Keep away from heat and open flame. Keep container closed. Use with adequate ventilation. Harmful if swallowed. Rinse empty container with water and discard. This product is intended for institutional and institutional use only. Manufacturer will not be responsible for any injury, loss, or damage, if product is used in any manner not in compliance with label directions or if precautions are not observed.

FIRST AID

EYES: Flush with large amounts of water for at least 15 minutes; consult physician. IF SWALLOWED: Do not induce vomiting or give anything by mouth to an unconscious person. Consult physician. EXTERNAL: Immediately flush with water.

Kinzua Environmental, Inc., Cleveland, Oh. 44114
800-233-5079 / www.kinzuachem.com