

KE-56

PINK LOTION HAND SCRUB

FOR ALL WASHROOMS

Lotion hand soap replaces expensive, messy bar soaps and powders

SUPERB CLEANSING

Effective, but gentle grease-cutting agent. It thoroughly cleans without stripping skin of its natural oils.

HELPS PREVENT CHAPPING

Absolutely neutral in action. Contains no harmful alkali.

LEAVES NO STICKY AFTER-FEEL

The free-rinsing ingredients allow it to rinse away easily with water.

BIODEGRADABLE

Combines cleaning properties of an excellent soap with the emollients of a fine lotion. Produces a luxurious lather .

CONCENTRATED

Can be used full strength or diluted 1:1 for economical hand soap

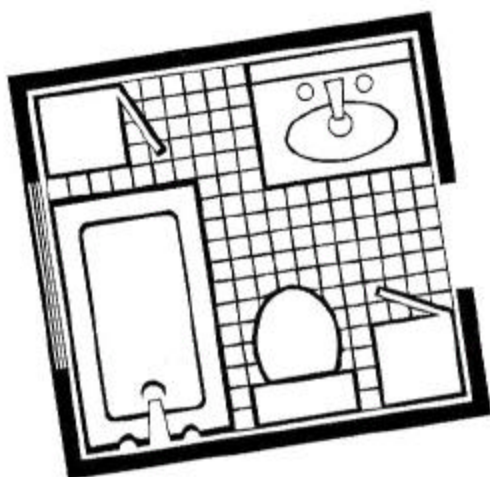

Kinzua Environmental, Inc., Cleveland, Oh. 44114
800-233-5079 / www.kinzuachem.com

DESCRIPTION

Everything that you expect from a quality hand cleaner. An effective, economical lotionized hand cleaner with blends of biodegradable surfactants that produces rich, copious suds. Excellent cleaning yet gentle to the skin in hot or cold, hard or soft water. Will not harden in wall-mounted, push-type dispensers. Remains effective and will not separate when diluted with water.

APPLICATIONS

Non-clogging ability makes it unequalled for use in:
schools, industrial and institutional washrooms, health clubs, factories,
fire stations, hotels, kitchens, restaurants, offices, service stations

SPECIFICATIONS

Appearance: Pink liquid
Fragrance: Cherry
Detergency: Very good
Foaming: High
pH: 8.00
Viscosity: Light syrup
Ecology: Biodegradable, non-toxic, phosphate free

PRECAUTIONS

Keep out of the reach of children. Possible eye irritant. Do not take internally. Rinse empty container with water and discard. This product is intended for industrial and institutional use only. Manufacturer will not be responsible for any injury, loss, or damage, if product is used in any manner not in compliance with label directions or if precautions are not observed.

FIRST AID

EYES: Flush with large amounts of water for at least 15 minutes; consult physician. IF SWALLOWED: Induce vomiting. Drink large quantities of water. Consult physician.